



POWERCORE
THE POWER OF CONTROL

Automatic sliding door operators



SESAMO

POWERCORE

The new sliding door operators with **POWERCORE** technology are suitable for any type of automatic entrance and are characterized by their modularity, whether they are standard or telescopic sliding doors. The mechanical and electronic characteristics make those operators easy to install and durable over time.

The **POWERCORE** series is equipped with advanced technological solutions, which respect and optimize all the different parameters in real time to save energy and installation time as much as possible.

Modular

With **POWERCORE**, various solutions can be flexibly implemented.

The modular system lends itself to various combinations for all types of sliding doors: standard, escape route and telescopic.

Upgrading existing systems (Dualcore) is easy, fast and cost-effective with the specific retrofit KIT.



POWERCORE for sliding doors

POWERCORE PL55, PW100, PW140, PW250

Heavy-duty operator for single-leaf sliding doors from 55 to 400 kg, 55+55 kg up to 250+250 kg in the double-leaf version.

POWERCORE ER140

The specific solution for escape route and emergency exit applications.

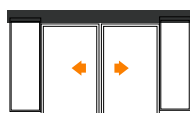
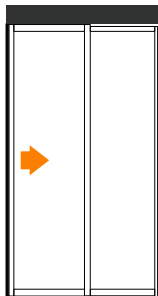

POWERCORE T for POWERCORE PWT80 telescopic sliding doors

POWERCORE PWT80

The solution for telescopic double-leaf sliding doors 100+100 kg, 80+80+80+80 kg in the four-leaf version.

POWERCORE ERT80

The telescopic sliding door solution for escape route and emergency exit applications.

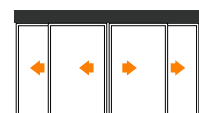
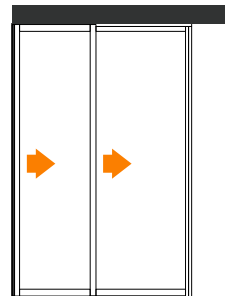

POWERCORE		PL55 – PW100 PW140 – PW250	ER 140 – ERT 80
Modular structure with tracks of different capacities		v	v
Logics functions	- Manual/Off	v	v
	- Automatic	v	v
	- Stop open	v	v
	- Exit only	v	v
	- Stop close	v	v
	- Partial opening	v	v
Multiple types of accessories for door locks		v	v
Verified according to EN 16005		v	v
Protection of the main/secondary closing edges according to EN 16005		v	v
Parameter setting and commissioning via integrated display and buttons		v	v
Programming via Digidor selector switch		o	v
SESAMO App (Bluetooth)		o	o
Wifi module for night opening/reset/closing		o	o
Automatic opening/closing in the event of a power failure (battery required)		v	ER battery KIT as standard for opening only
Emergency battery operation (battery required)		v	NA
12 V DC output for external peripherals		v	v
Fault/fault memory display with error codes		v	v
Interface for connecting sensors and other CANopen devices		v	v
Functions			
Pharmacy function		v	NA
Door status feedback with contact		v	v
Doorbell contact		v	v
Interlock logic		v	NA
Synchronized mode		v	v
Night function		v	v
Opening by emergency push button		v	v
Stop with emergency push button		v	NA
Adjustable partial opening		v	v
Slide and Go		v	v
Automatic opening in the event of a fault		NA	v

Optional accessories	Standard Sliding Doors	Sliding doors for escape routes
Electromechanical locking devices on carriage	o	Bistable lock only
Manual release of the electromechanical locking device	o	o
Magnetic locking device, carriage or pulley	o	o
Locking device with electromagnetic brake on electric motor	o	o
Battery kit 24 V 1.2Ah	o	NA
NiMH battery kit 24 V 1Ah	o	v
Wi-Fi module for remote door opening	o	o
Auxiliary relay contact	o	o

v as standard | o optional | NA not applicable

Operators for sliding doors

- 1 Transmission pulley
- 2 Carriages
- 3 Motor
- 4 Electronic board
- 5 Power supply switching
- 6 Battery

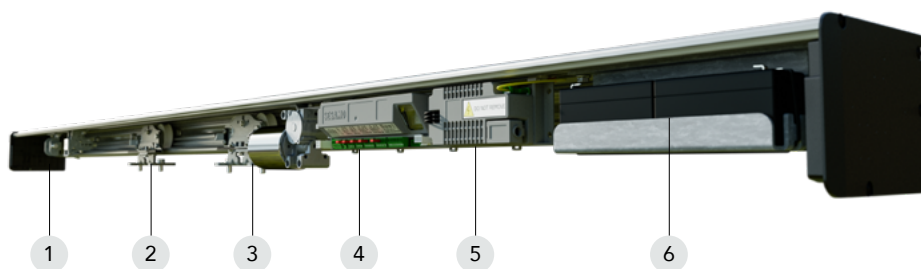

Technical details	Standard sliding door				Sliding door for escape routes
	PL55	PW100	PW140	PW250	ER140
Door parameters					
Operator length min.	1600 mm 1 leaf 1800 mm 2 leaves	1600 mm 1 leaf 1800 mm 2 leaves	1600 mm 1 leaf 1800 mm 2 leaves	1600 mm 1 leaf 1800 mm 2 leaves	1600 mm 1 leaf 1800 mm 2 leaves
Operator depth in mm	155	155	155	155	155
Operator height in mm	115	115	115	115	115
For escape routes / emergency	-	-	-	-	
Capacity 1 leaf maximum capacity	1 x 55 kg	1 x 140 kg	1 x 160 kg	1 x 400 kg	1 x 160 kg
Maximum load capacity 2 leaves	2 x 55 kg	2 x 100 kg	2 x 140 kg	2 x 250 kg	2 x 140 kg
Clear passage width	700-3000 mm	700-3000 mm	700-3000 mm	700-3000 mm	800-3000 mm
Clear passage height	2000-3000 mm	2000-3000 mm	2000-3000 mm	2000-3000 mm	2000-3000 mm
Settings					
Opening speed (can be set in increments)	20 – 55 cm/s	20 – 70 cm/s	20 – 70 cm/s	20 – 40 cm/s	20 – 70 cm/s
Closing speed (can be set in increments)	10 – 40 cm/s	10 – 40 cm/s	10 – 40 cm/s	10 – 30 cm/s	10 – 40 cm/s
Hold opening time	0 - 240 s	0 - 240 s	0 - 240 s	0 - 240 s	0 - 240 s
Exit delay with night lock	0 – 60 s	0 – 60 s	0 – 60 s	0 - 60 s	0 – 60 s
Partial opening	30 - 90 %	30 - 90 %	30 - 90 %	30 - 90 %	30 - 90 %
Product specifications					
Supply voltage	230 V 50/60 Hz	230 V 50/60 Hz	230 V 50/60 Hz	230 V 50/60 Hz	230 V 50/60 Hz
Rated power	100 W	130 W	200 W	200 W	200 W
Frequency of use	intensive	continuous	continuous	continuous	continuous
IP protection	IP 20	IP 20	IP 20	IP 20	IP 20
Power supply external accessories	12 V DC/1A	12 V DC/1A	12 V DC/1A	12 V DC/1A	12 V DC/1A
Operating temperature	-10 / +55°C	-10 / +55°C	-10 / +55°C	-10 / +55°C	-10 / +55°C
Standards and tests					
Certification according to Low Voltage and Electromagnetic compatibility directives	✓	✓	✓	✓	✓
Product tested and compliant with EN 16005	✓	✓	✓	✓	✓
Production according to ISO 9001	✓	✓	✓	✓	✓

Operators for telescopic sliding doors

- 1 Motor
- 2 Carriages
- 3 Electronic board
- 4 Power supply switching
- 5 Battery
- 6 Double pulley module

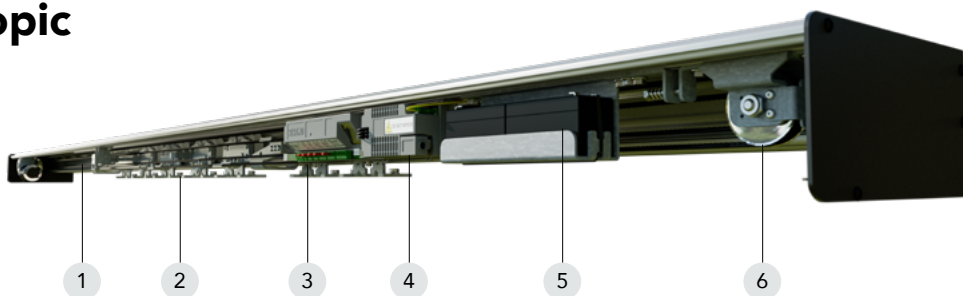

Technical details	Standard sliding door	Sliding door for escape routes
Door parameters	PWT80	ERT80
Operator length min.	1400 mm 2 length 2600 mm 4 leaves	1400 mm 2 length 2600 mm 4 leaves
Operator depth in mm	246	246
Operator height in mm	118	118
For escape routes / emergency	-	
Maximum load capacity 2 leaves	2 x 100 kg	2 x 100 kg
Maximum load capacity 4 leaves	4 x 80 kg	4 x 80 kg
Clear passage width*	800-3000 mm	800-3000 mm
Clear passage height	2000-3000 mm	2000-3000 mm
Settings		
Opening speed (can be set in increments)	20 – 70 cm/s	20 – 70 cm/s
Closing speed (can be set in increments)	10 – 40 cm/s	10 – 40 cm/s
Hold opening duration	0 – 240 s	0 – 240 s
Exit delay with night lock	0 – 60 s	0 – 60 s
Partial opening	30 – 90%	30 – 90%
Power supply		
Supply voltage	230 V, 50/60 Hz	230 V, 50/60 Hz
Rated power	200 W	200 W
Frequency of use	continuous	continuous
IP protection	IP 20	IP 20
Power supply for external devices with mains connection	12 V DC/1A	12 V DC/1A
Operating temperature	-10 / +55°C	-10 / +55°C
Standards and tests		
Certification according to Low Voltage and Electromagnetic Compatibility directives	v	v
Product tested and compliant with EN 16005	v	v
Production according to ISO 9001	v	v

v as standard | o optional | NA not applicable

Profili cassa disponibili

Sesamo profiles are designed to cover a wide range of configurations, for operators with a height of 115 mm and are suitable for both wall and corridor installations.

Light Track

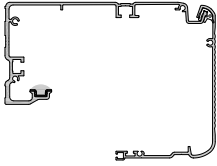

Max.
1 x 55 kg; 2 x 55 kg

Standard Track

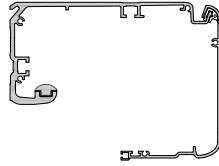

Max.
1 x 160 kg; 2 x 140 kg

Heavy Track

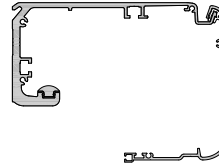

Max.
1 x 400 kg; 2 x 250 kg

Telescopic Track

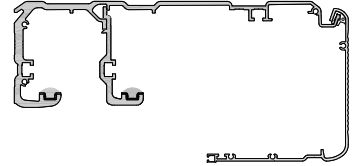

Max.
2 x 100 kg; 4 x 80 kg

C OVER ACCESSORIES:

Gap closer profiles and brushes

Aluminium

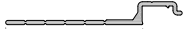

PVC

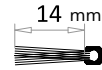
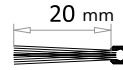
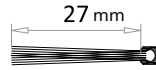

Vertical sections

Magnum section with Fixed

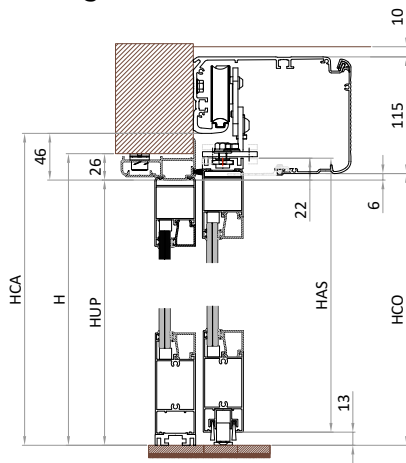

S30 Section with Fixed

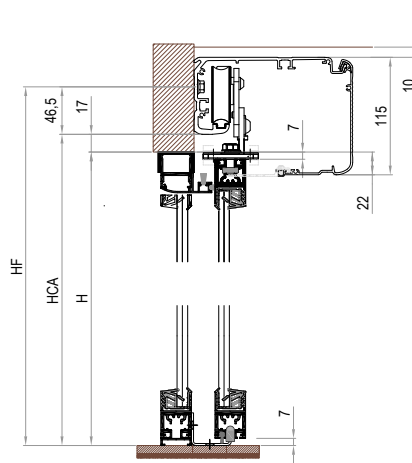

Twenty Section with Fixed

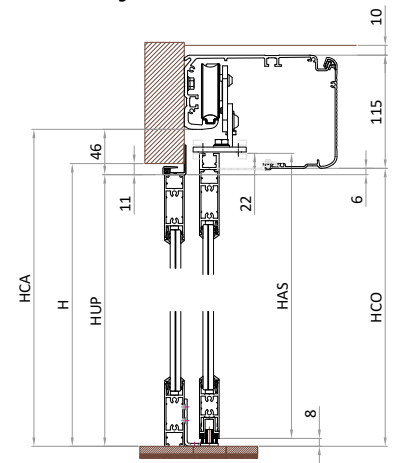

Magnum Telescopic Section

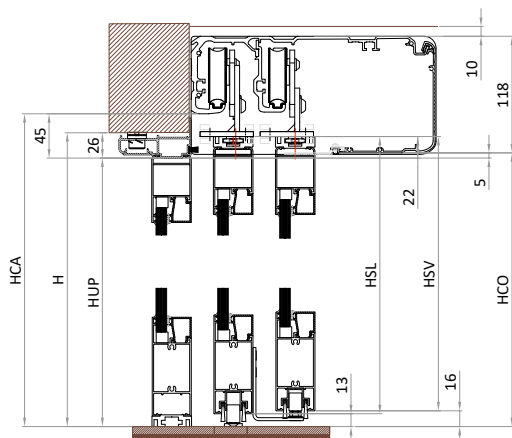

S30 Telescopic Section

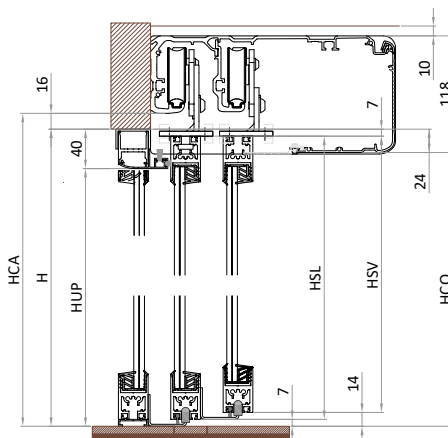

Twenty Telescopic Section

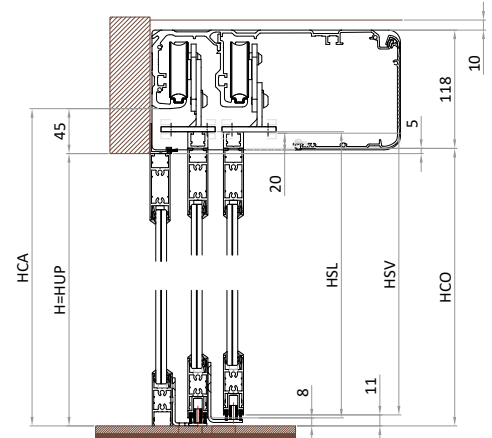

Battery



Standard batteries: 2 lead-acid batteries with charging board, allow emergency opening in case of power failure.

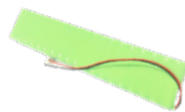

NiMH batteries: nickel metal hydride batteries with charging board, allow in the event of a power failure to perform about 100 cycles or standby 10 hours.

Locking devices

Electromagnetic locking devices can also be used on escape route doors, ensuring that the doors are locked during normal daytime operation.



FAIL SECURE lock: in the event of a power failure, it remains locked. Unlocking is possible through a release device.



Magnetic locking on the carriage: electromagnetic locking device applicable on limit door stopper when the door is closed.

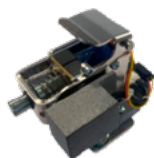

BISTABLE block: in the event of a power failure, it remains in the selected position at the time of the power failure. Unlocking is possible through a release device.



Magnetic locking on the pulley: electromagnetic locking device integrated into the belt pulley.



FAIL SAFE lock: in the event of a power failure, it remains unlocked, sliding door can be opened manually.



Motor brake: Electromagnetic locking device integrated into the motor, providing precise and safe stopping.

Logic selectors

Sesamo logic selectors allow you to set different operating modes of the automatic door quickly and easily. To meet different needs, they are available in several variants: from the mechanical version (with key or knob), to full digital, with protection by locking code or TAG card, or by Digidor selector/programmer



Roto K3: 3 positions with key, wall or flush mounting.



Roto K5: 5 positions with key, wall or flush mounting.



RS4: Rotary selector switch for header mounting, 4-logic switch only.



Roto M4: 5 positions with knob, wall mounting.



Digidor: Selector switch with display: commissioning, parameter adjustment, calendar and maintenance.



Icon: Digital selector with capacitive keypad and micro-USB connector for quick connection with Digidor, including transponder reader.



Sesamo App

The Powercore series operators can be optionally equipped with Digidor BT, an essential interface for using the Sesamo App*.

The application works on two levels, first with exclusive access for of the installer, second for the end user with limited functions.

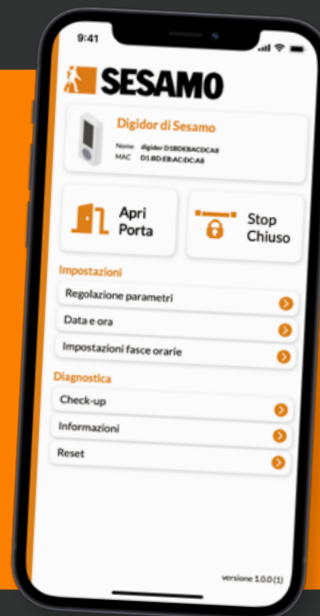

Program Functions:

Stop closed - stop open - exit only - automatic - partial exit only - partial automatic - partial stop open - manual.

Configurations:

Adjustment of parameters, date and time, setting of time slots of the calendar menu, start-up (commissioning), maintenance, reduced logic, language selection, Sesamo Tag association

Door status reports

Immediate information on the port status and, in the event of a fault, notification of the type of fault

Battery operation message and information on connection and remaining charge

Door open signal, single pulse

Customer benefits

- **Convenience and ease of use**, via smartphone it is possible to change operation logic of the door, check the operating status and activate an opening.
- **Easy control** of events without special knowledge.
- **No connection** needed to the building network.



**The application is free but can only be used with the use of the Digidor BT programmer selector, sold separately and as a complementary accessory to the operator.*



Strada Gabannone, 8/10 • 15030 Terruggia (AL) ITALIA
Phone: +39 0142 403 223 • Fax: +39 0142 403 256
info@sesamo.eu • www.sesamo.eu

